

# PORT OF BOSTON

EST 1884

Port of Boston Ltd, Boston  
Lincolnshire PE21 6BN

Tel: 01205 365571 Fax: 01205 310126

<http://www.victoriagroup.co.uk>

Dated: 01.06.20

## **NOTICE TO MARINERS 038/2020**

### **Boston – Town Bridge Works**

Mariners are advised that commencing 10<sup>th</sup> June 2020 works will be carried on the metal structure of the Town Bridge and are expected to be complete on 1<sup>st</sup> September 2020.

These works will restrict navigation to craft passing below the bridge and it is therefore imperative that all Mariners requiring to pass should check the suitability of their vessels as part of their voyage plan, prior to commencing their voyage.

Attached to this NTM are drawings showing the extent of the works and associated restriction to navigation.

Harbour Master  
Port of Boston Ltd

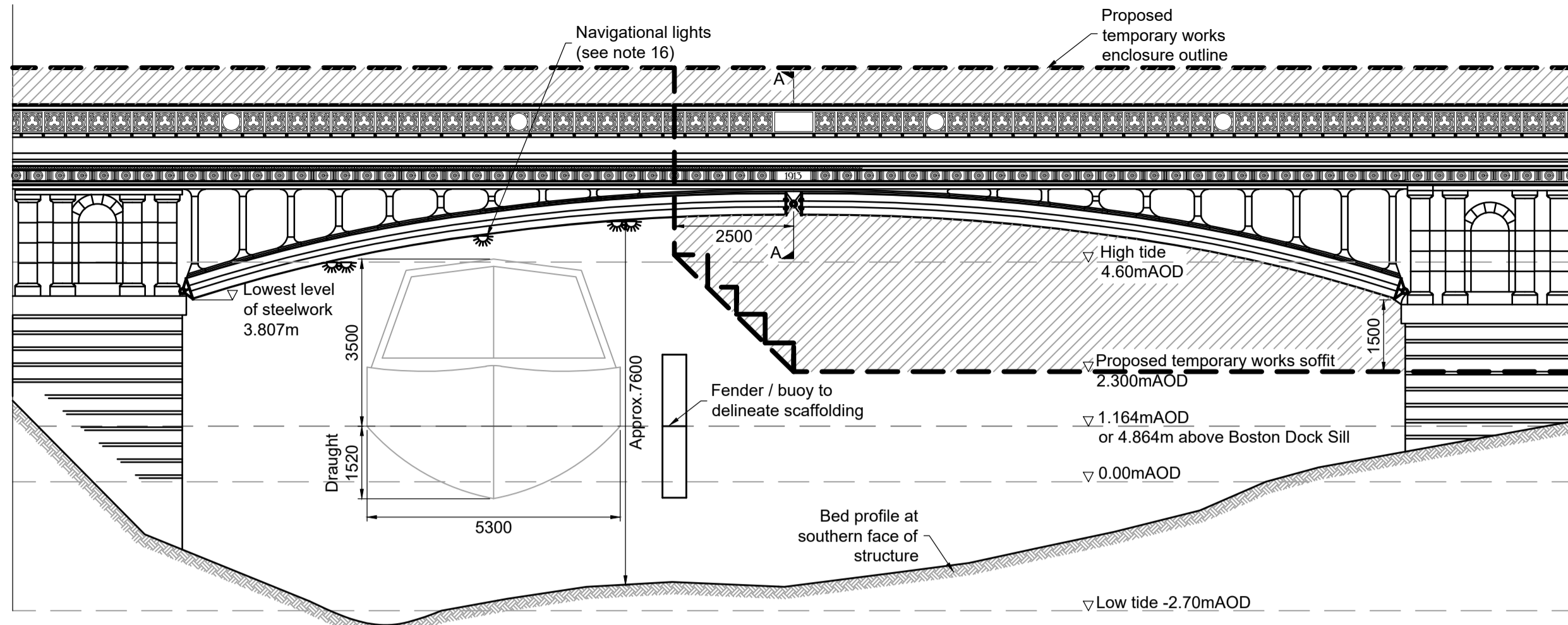

SOUTHERN ELEVATION OF STRUCTURE (1st phase)  
Scale 1:100

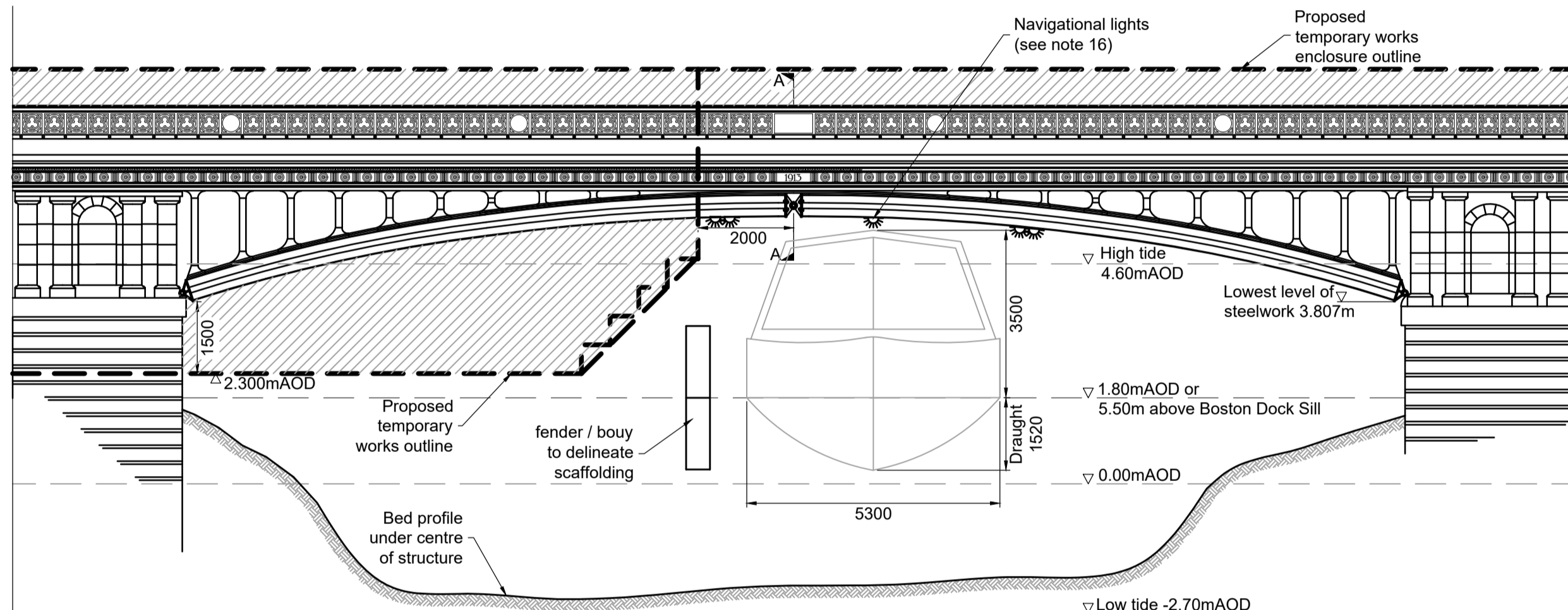

SOUTHERN ELEVATION OF STRUCTURE (4th phase)  
Scale 1:100

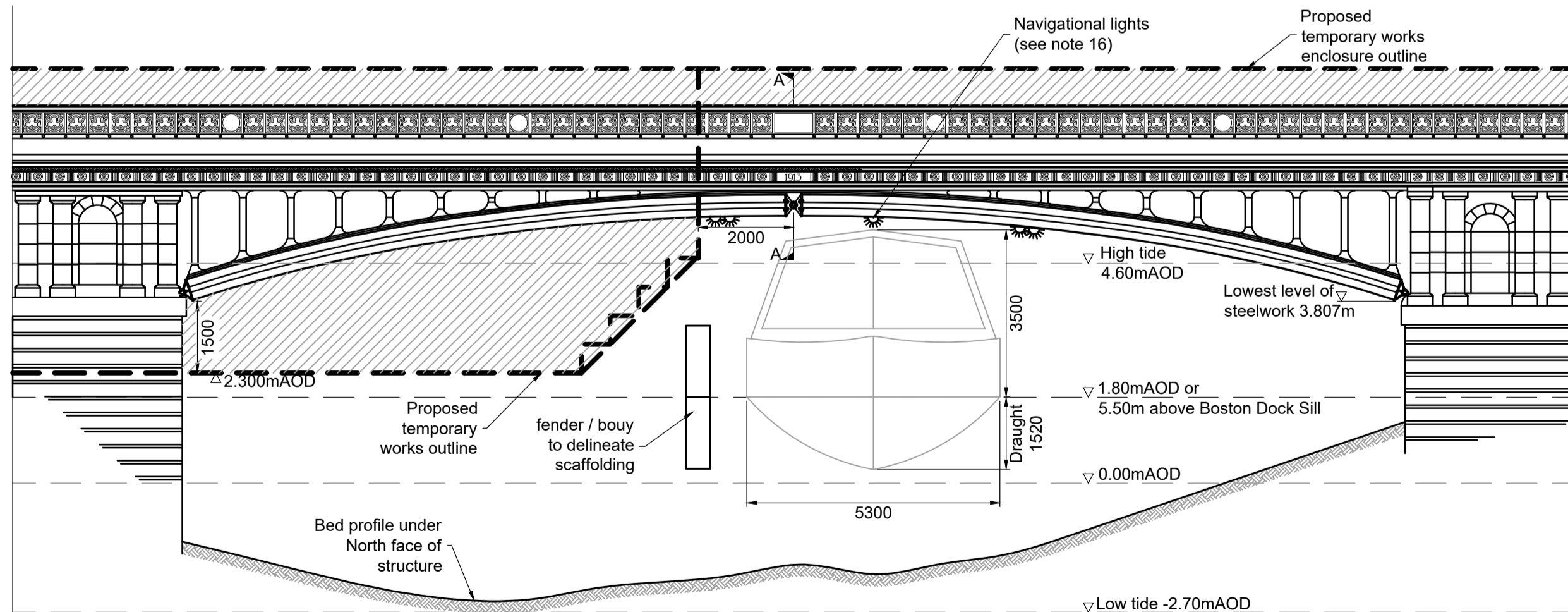

SOUTHERN ELEVATION OF STRUCTURE (4th phase)  
Scale 1:100

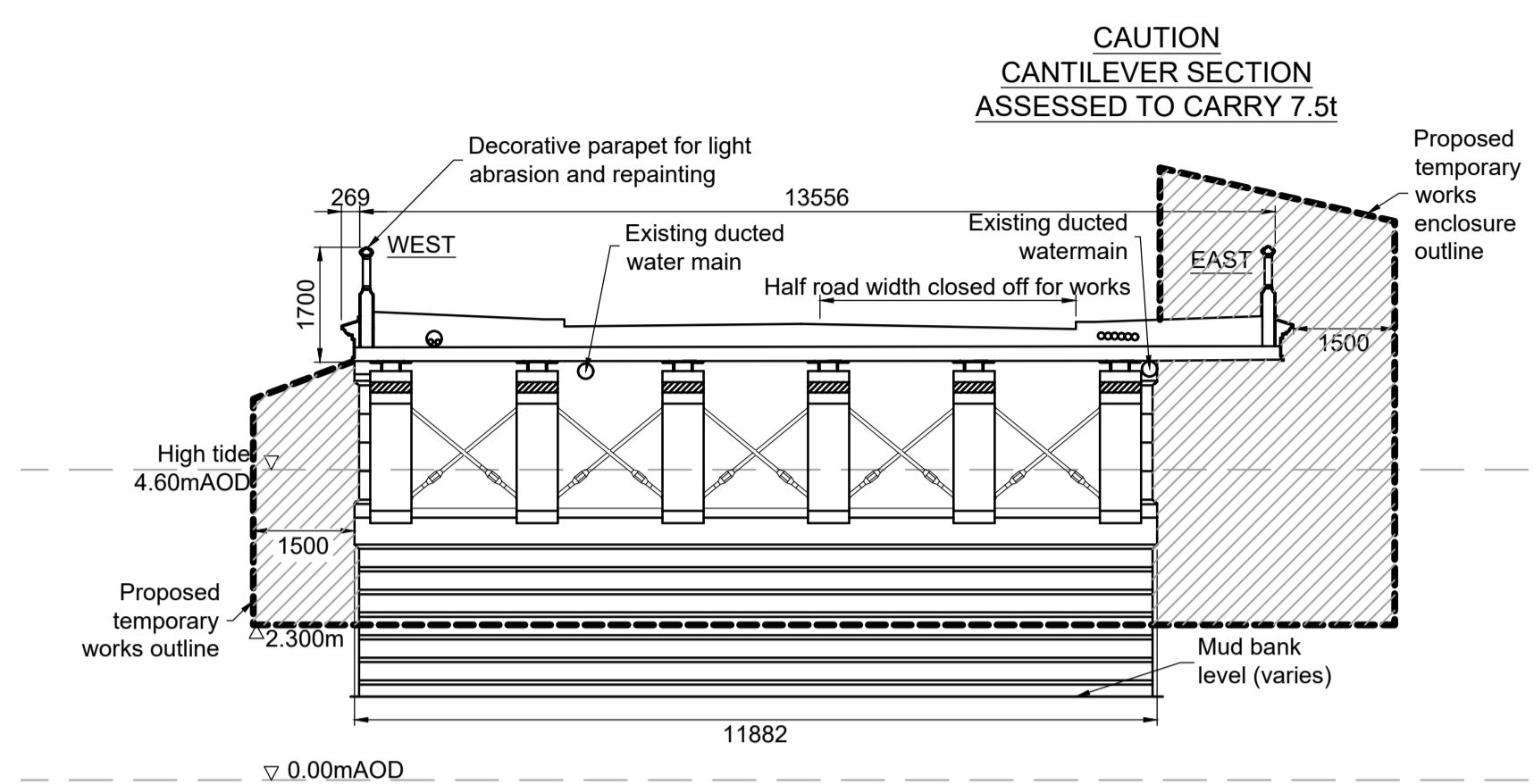

PROPOSED TEMPORARY WORKS ENVELOPE  
DEVELOPED SECTION (A - A) THROUGH STRUCTURE  
(internal cross members not shown for clarity)  
Scale 1:100

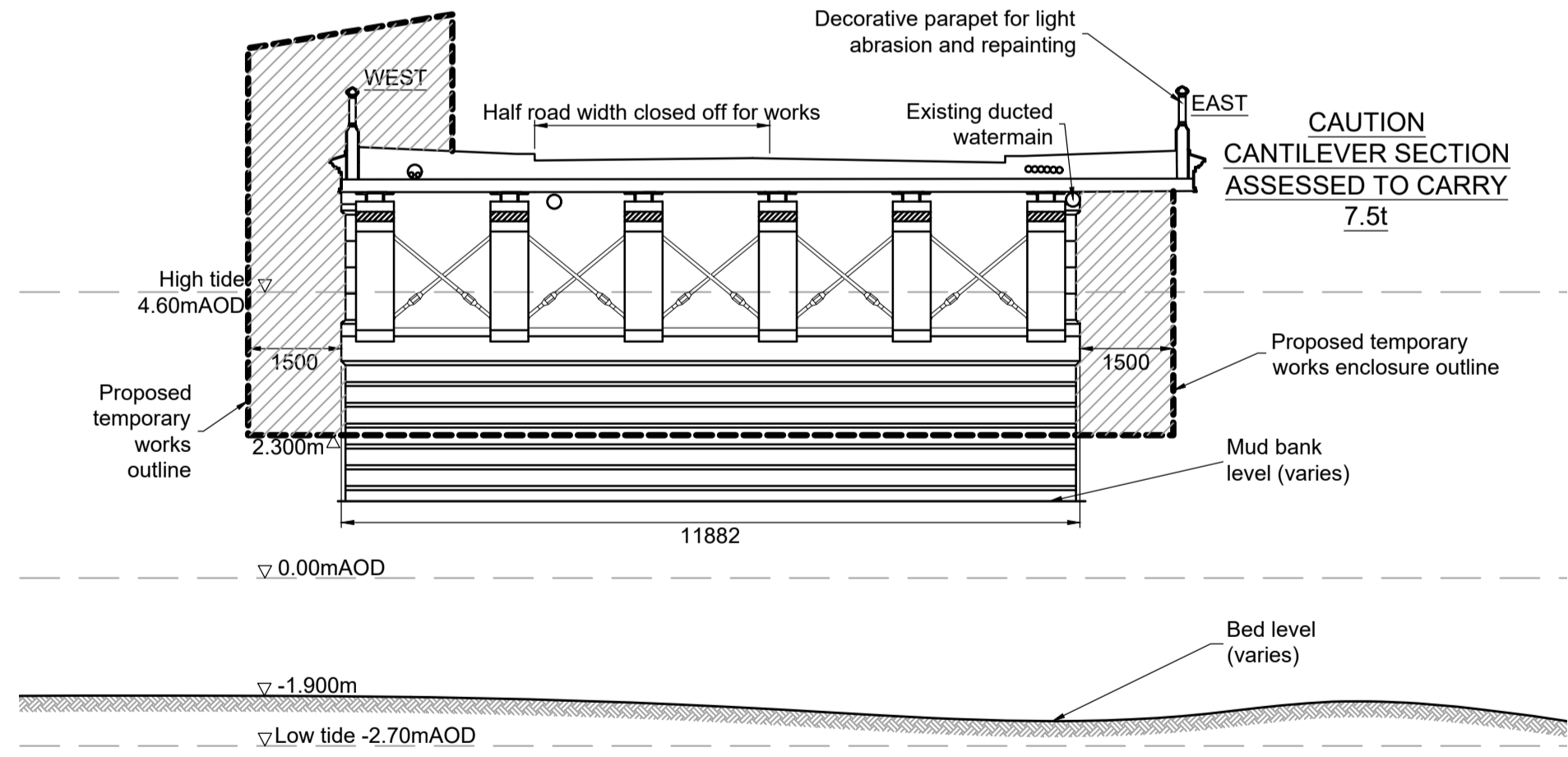

TEMPORARY WORKS ENVELOPE  
DEVELOPED SECTION (A - A) THROUGH STRUCTURE  
(internal cross members not shown for clarity)  
Scale 1:100

- NOTES**  
General
- All dimensions are in millimetres unless otherwise stated.
  - Archive drawings have been used in the production of this drawing which may have discrepancies due to conversions into metric measurements.
  - Levels referred to on this drawing relate to Ordnance Survey datum Newlyn.
  - Work on the structure is to repaint the structural metal members of the bridge and the decorative parapets, repair any defects found in the metal members, re-point or refurbish any stone defects in the abutments and wingwalls.
  - Refer to drawings 3000, 3001 and 3002 for details referred to on this drawing.
  - The works are proposed to be phased to accommodate the waterway users.
  - Modular style pontoon units are shown in the drawing but the Contractor may use another proprietary system as agreed with the Client as long as it satisfies the requirements of shielding the temporary works from river traffic and highlighting the potential hazard in the watercourse.
  - Existing Structure
  - Town Bridge spans the River Haven in the town of Boston.
  - The river is tidal at this point and the lowest section of the bridge structural steel / iron is regularly submerged.
- Constraints**
- The works are subject to the PORT OF BOSTON constraints as discussed and agreed between LCC and Harbour Master Captain Richard Walker.
  - Consultation has revealed that the works cannot obstruct the whole span of the watercourse.
  - The works will also be subject to Environment Agency Permit which LCC will seek.
  - Works are to be undertaken with one lane of the carriageway and pedestrian footway over the bridge closed for site access and equipment areas.
  - Any detritus or arisings from the works will be contained and restricted from entering the watercourse. Encapsulation of the works will be constantly monitored for any materials escaping.
  - Sign boards with the words "CAUTION - WORKS IN PROGRESS" in red letters 150mm high on a white background shall be erected on both banks of the river at a distance of 100 and 200m upstream and downstream of the works.
  - By Night, lights shall be displayed to define the navigation opening upstream and downstream of the works. 2 red lights side by side, 300mm apart should be fixed at the extremity of the navigable channel and in addition an amber light should be displayed upstream and downstream of the works to mark the centre of the navigation opening.

**PRICING**  
(FOR PRICING PURPOSES ONLY - DO NOT USE FOR CONSTRUCTION)  
FOR THIRD PARTY USE, THIS DRAWING SHALL BE DEEMED CURRENT ONLY AT THE DATE OF APPROVAL. PLEASE CHECK FOR AMENDMENTS BEFORE USE

Revision	Description	Drawn By	CAD By	Approved By	Approval Date

Amendment Details  
Drawing 1st Approval  
1st Approval by: RAW Date: 5/3/2020

Drawn/Designed by: ST CAD Drawing Creation  
Created By: ST Date: 17/02/2020

Scale: @A1  
Primary: 1:100 (Do not scale from this drawing)  
Secondary:  

**Lincolnshire**  
COUNTY COUNCIL  
Highways Alliance  
TECHNICAL SERVICES PARTNERSHIP  
CROWN HOUSE  
GRANTHAM STREET  
LINCOLN  
LN2 1BD  
Customer Service Centre 01522 783070

Drawing Number: 0589 / 01 / 3004  
Scheme Reference: ID Number: Drawing Series No.  
Alternative Scheme Code: Road No: C785  
Parish: BOSTON  
Structure No: 34/24/70 SCN No: Site Ref:

Description:  
TOWN BRIDGE  
BRIDGE REPAINTING WORKS 2020  
PROPOSED TRAFFIC AND WATERWAY MANAGEMENT 1 of 2

**NOTES**

- General**
- All dimensions are in millimetres unless otherwise stated.
  - Archive drawings have been used in the production of this drawing which may have discrepancies due to conversions into metric measurements.
  - Levels referred to on this drawing relate to Ordnance Survey datum Newlyn.
  - Work on the structure is to repaint the structural metal members of the bridge and the decorative parapets, repair any defects found in the metal members, re-point or refurbish any stone defects in the abutments and wingwalls.
  - Refer to drawings 3000, 3001 and 3002 for details referred to on this drawing.
  - The works are proposed to be phased to accommodate the waterway users.
  - Modular style pontoon units are shown in the drawing but the Contractor may use another proprietary system as agreed with the Client as long as it satisfies the requirements of shielding the temporary works from river traffic and highlighting the potential hazard in the watercourse.

- Existing Structure**
- Town Bridge spans the River Haven in the town of Boston.
  - The river is tidal at this point and the lowest section of the bridge structural steel / iron is regularly submerged.

- Constraints**
- The works are subject to the PORT OF BOSTON constraints as discussed and agreed between LCC and Harbour Master Captain Richard Walker.
  - Consultation has revealed that the works cannot obstruct the whole span of the watercourse.
  - The works will also be subject to Environment Agency Permit which LCC will seek.
  - Works are to be undertaken with one lane of the carriageway and pedestrian footway over the bridge closed for site access and equipment areas.
  - Any detritus or arisings from the works will be contained and restricted from entering the watercourse. Encapsulation of the works will be constantly monitored for any materials escaping.
  - Sign boards with the words "CAUTION - WORKS IN PROGRESS" in red letters 150mm high on a white background shall be erected on both banks of the river at a distance of 100 and 200m upstream and downstream of the works.
  - By Night, lights shall be displayed to define the navigation opening upstream and downstream of the works. 2 red lights side by side, 300mm apart should be fixed at the extremity of the navigable channel and in addition an amber light should be displayed upstream and downstream of the works to mark the centre of the navigation opening.

**PRICING**  
(FOR PRICING PURPOSES ONLY - DO NOT USE FOR CONSTRUCTION)

FOR THIRD PARTY USE, THIS DRAWING SHALL BE DEEMED CURRENT ONLY AT THE DATE OF APPROVAL. PLEASE CHECK FOR AMENDMENTS BEFORE USE

Rev	Description	Drawn By	CAD By	Approved By	Approval Date

Revision: Description Drawn By: CAD By: Approved By: Approval Date

Amendment Details Drawing 1st Approval

1st Approval by: **RAW** Date: **5/3/2020**

Drawn/Designed by: **ST** CAD Drawing Creation  
Created By: **ST** Date: **17/02/2020**

**Scale:**  
Primary: **1:200** (Do not scale from this drawing)  
Secondary:

**Lincolnshire**  
COUNTY COUNCIL

**Highways Alliance**

TECHNICAL SERVICES PARTNERSHIP  
CROWN HOUSE  
GRANTHAM STREET  
LINDOLN  
LN2 1BD  
Customer Service Centre 01422 782070

ISO 9001:2015  
REGISTERED  
FIS 20706

Drawing Number: **0589** / 01 / **3005**  
Scheme Reference ID Number Drawing Series No.

Alternative Scheme Code: Road No: **C785**  
Parish: **BOSTON**  
Structure No: **34/24/70** SCN No: Site Ref:

Description:  
**TOWN BRIDGE**  
**BRIDGE REPAINTING WORKS 2020**  
**PROPOSED TRAFFIC AND WATERWAY**  
**MANAGEMENT 2 of 2**

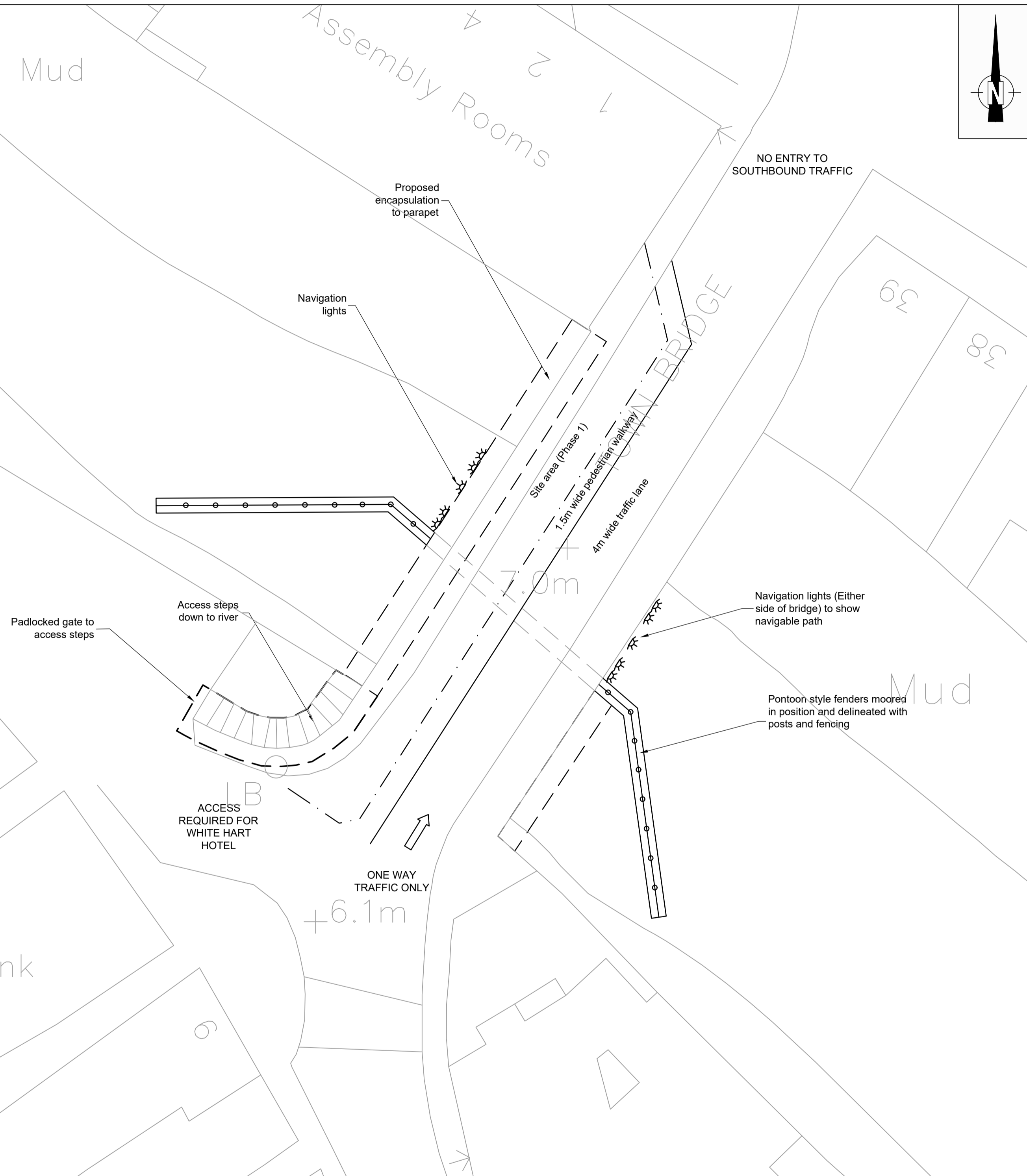

**TOWN BRIDGE WATERWAY**  
**TEMPORARY WORKS PLAN (1st Phase)**  
Scale 1:200

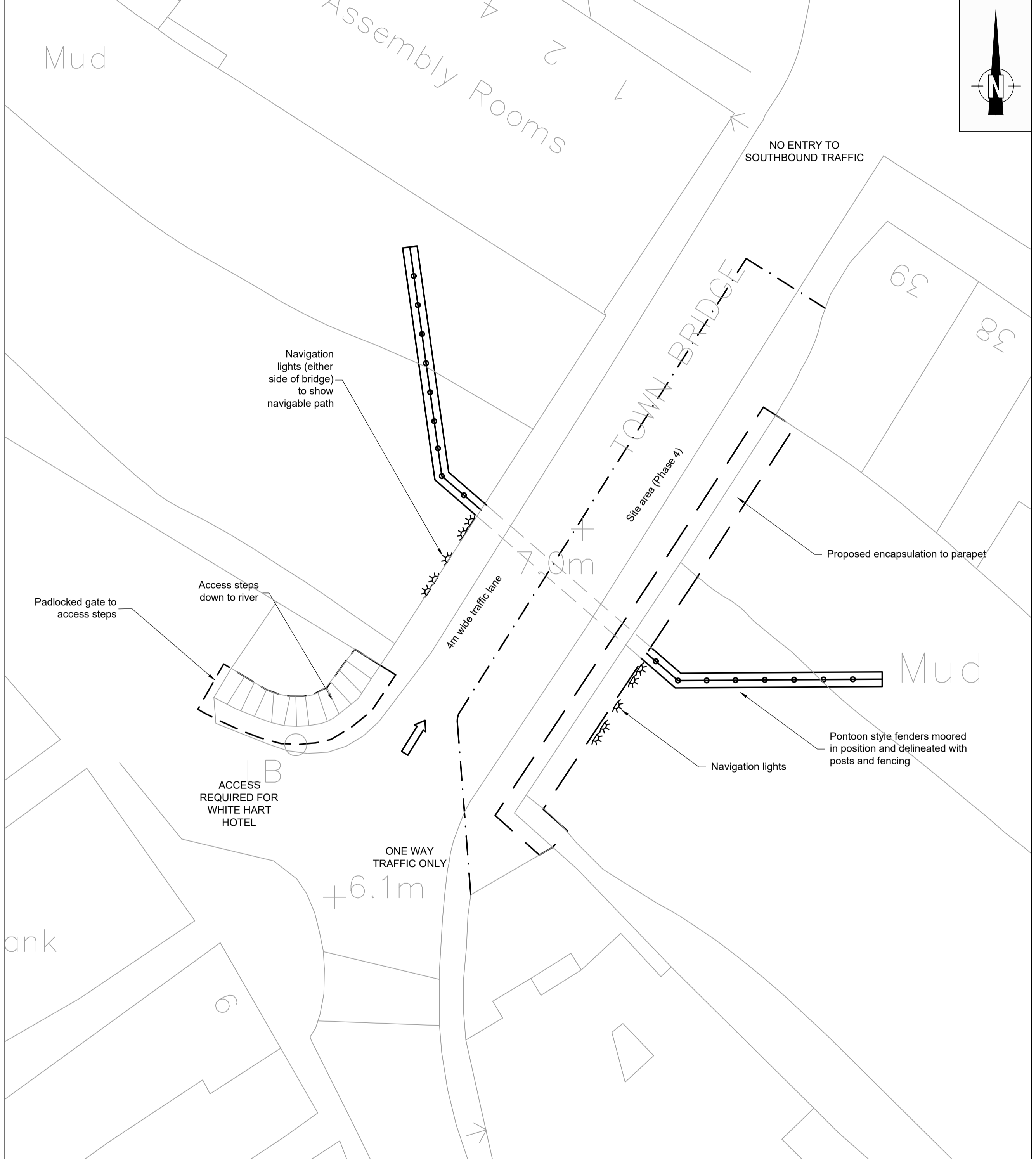

**TOWN BRIDGE WATERWAY**  
**TEMPORARY WORKS PLAN (4th Phase)**  
Scale 1:200

